

Banco de jardim - do tipo SOCRATES

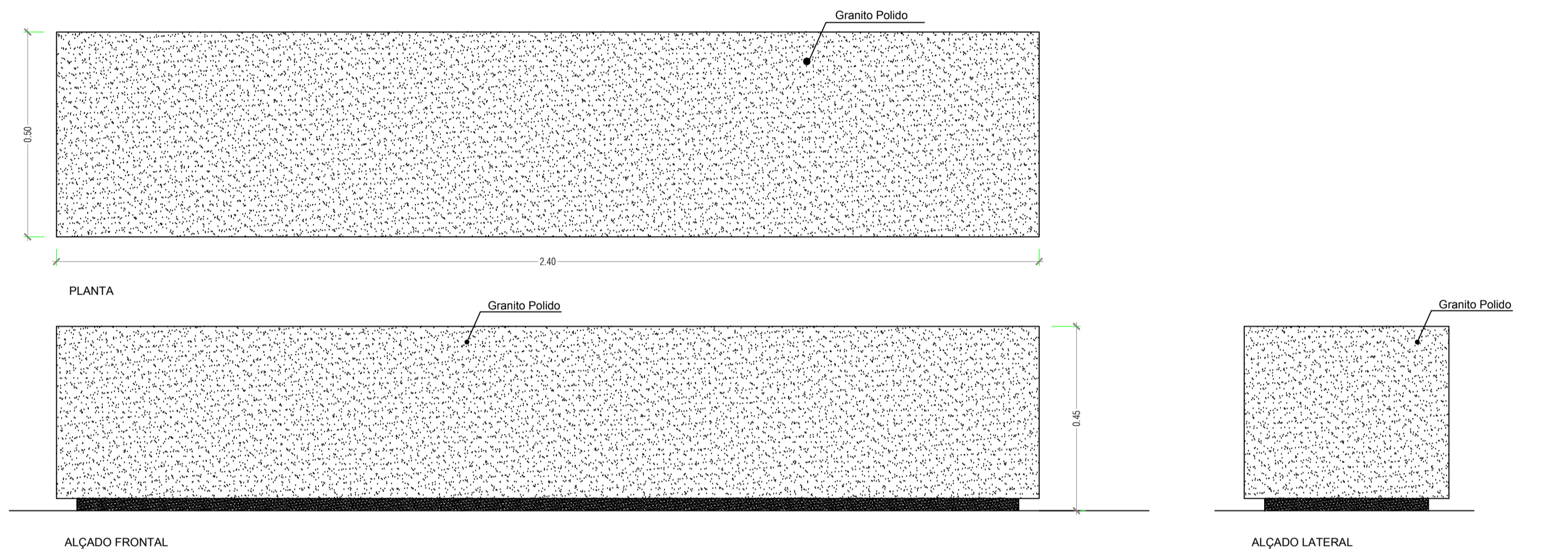

Papeleira - do tipo YOR, ref.:14-2

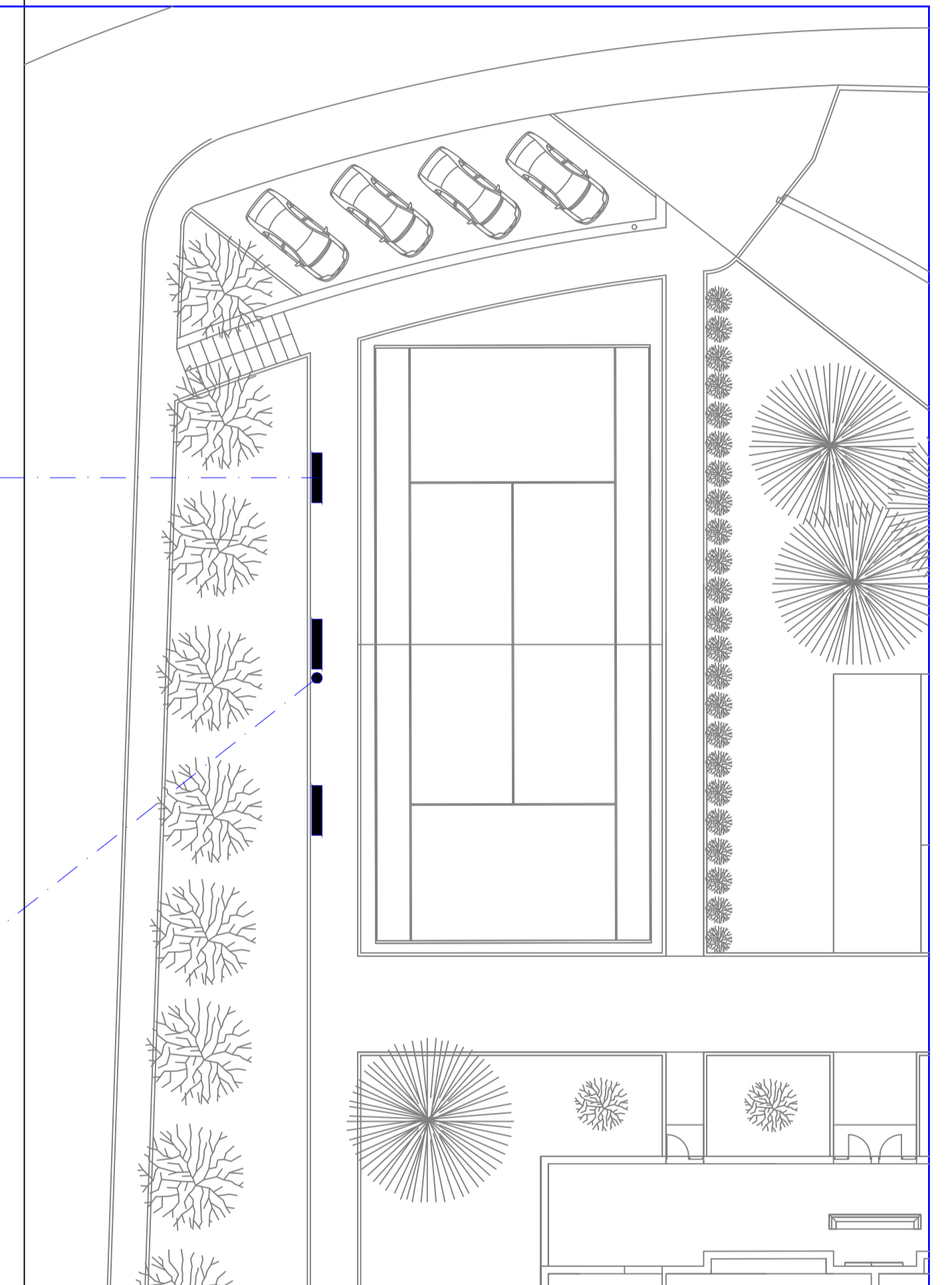
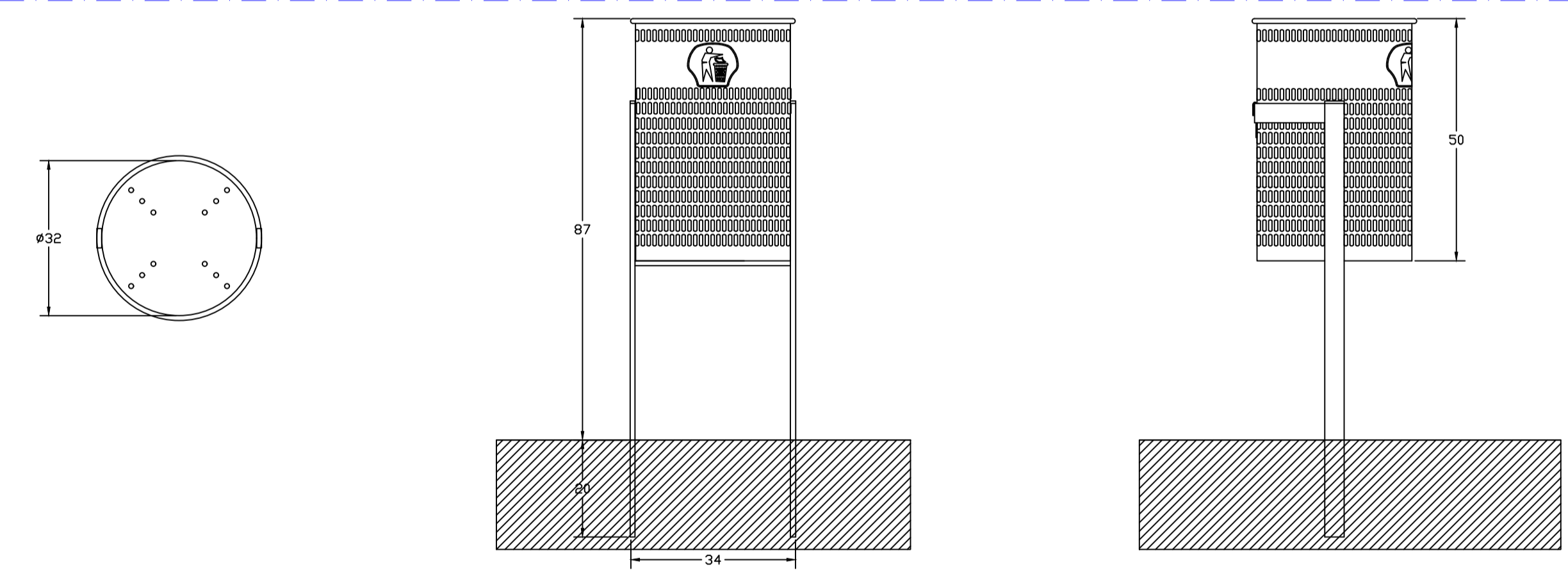

ARRANJOS EXTERIORES DO ALOJAMENTO LOCAL DOS POSSACOS

Desenho: PORMENOR DE PAVIMENTO / CALDEIRA
Requerente: Câmara Municipal de Valpaços
Desenho: Projector: Aprovou:

CMV
D E C D
Data: Fev. 2024
Esc.: 1/20 **06**